

ATTACHMENT A

PROPOSED 15-DAY MODIFICATIONS TO THE AMENDMENTS TO CP-201: CERTIFICATION PROCEDURE FOR VAPOR RECOVERY SYSTEMS AT GASOLINE DISPENSING FACILITIES

[Note: The originally proposed modifications to the regulatory language are shown in underline to indicate additions and ~~striketrough~~ to indicate deletions. The proposed 15-day modifications to the proposed regulations are shown in double underline to indicate additions and ~~double striketrough~~ to indicate deletions. Only text with proposed 15-day modifications is included in this attachment. For all amendments to CP-201 approved by the Board during the October 25, 2018, hearing, refer to [Staff Report: Initial Statement of Reasons Appendix B](#). The symbol “***” means that intervening text not amended is not shown. [Bracketed text] is not part of the proposed amendments.]

CP-201 TABLE OF CONTENTS

<u>Section</u>	<u>Title</u>	<u>Page</u>
1.	GENERAL INFORMATION AND APPLICABILITY	1
1.1	Regulatory Requirements of Other State Agencies.....	1
1.2	Requirement to Comply with All Other Applicable Codes and Regulations	2
2.	PERFORMANCE STANDARDS AND SPECIFICATIONS.....	2
2.1	Performance Standards.....	2
2.2	Performance Specifications	2
2.3	Innovative System	2
2.4	Additional or Amended Performance Standards or Performance Specifications	2
3.	PHASE I PERFORMANCE STANDARDS AND SPECIFICATIONS.....	65
3.1	Phase I Efficiency/Emission Factor.....	75
3.2	Static Pressure Performance	78
3.3	Phase I Drop-Tubes with Over-Fill Prevention Devices.....	8
3.4	Phase I Vapor Recovery and Product Adaptors.....	8
3.5	Pressure/Vacuum Vent Valves	9
3.6	Spill Containers	10
3.7	Vapor Connections and Fittings.....	10
3.8	Materials Compatibility with Fuel Blends.....	10
4.	PHASE II PERFORMANCE STANDARDS AND SPECIFICATIONS APPLICABLE TO ALL PHASE II VAPOR RECOVERY SYSTEMS.....	1210
4.1	Phase II Emission Factor/Efficiency.....	1312
4.2	Static Pressure Performance	1413

4.3	Spillage	1514
4.4	Compatibility of Phase II Systems with Vehicles Equipped with ORVR Systems ...	1614
4.5	Compatibility of Phase II Systems with Phase I Systems	1615
4.6	Underground Storage Tank Pressure Criteria	1615
4.7	Nozzle Criteria	1716
4.8	Liquid Retention	182127
4.9	Nozzle/Dispenser Compatibility	182127
4.10	Unihose Multi-Product Dispenser (MPD) Configuration	182127
4.11	Vapor Return Piping	182127
4.12	Liquid Condensate Traps.....	192228
4.13	Connections and Fittings	192329
5.	PHASE II PERFORMANCE STANDARDS AND SPECIFICATIONS APPLICABLE TO BALANCE VAPOR RECOVERY SYSTEMS	212329
5.1	Balance Nozzle Criteria	222430
5.2	Dynamic Pressure Drop Criteria for Balance Systems	222430
5.3	Liquid Removal Systems	232531
6.	PHASE II PERFORMANCE STANDARDS AND SPECIFICATIONS APPLICABLE TO ALL ASSIST VAPOR RECOVERY SYSTEMS	232531
6.1	Nozzle Criteria	232531
6.2	Air to Liquid Ratio	242632
7.	PHASE II PERFORMANCE STANDARDS AND SPECIFICATIONS APPLICABLE TO ASSIST SYSTEMS UTILIZING A CENTRAL VACUUM UNIT	242632
7.1	Vacuum Levels Generated by the Collection Device	252732
7.2	Maximum Number of Refueling Points per Vacuum Device	252733
8.	PHASE II PERFORMANCE STANDARDS AND SPECIFICATIONS APPLICABLE TO SYSTEMS UTILIZING A DESTRUCTIVE OR NON-DESTRUCTIVE PROCESSOR...252733	252733
8.1	Processor Emission Factors	262834
8.2	Hazardous Air Pollutants from Destructive Processors	262834
8.3	Maximum Hydrocarbon Feedrate from the Processor.....	262834
8.4	Typical Load on the Processor	262834
8.5	Processor Operation Time	272834
9.	IN-STATION DIAGNOSTIC SYSTEMS.....272935	272935
9.1	General Requirements.....	272935
9.2	Monitoring Requirements.....	283036
9.3	Records.....	313339
9.4	Tampering Protection	323440
9.5	Readiness/Function Code	323440
9.6	Stored Vapor Recovery System Conditions	323440
9.7	Challenge Mode Testing.....	323440
9.8	Electronic Access	333541
10.	CERTIFICATION OF VAPOR RECOVERY SYSTEMS	333541
11.	APPLICATION PROCESS.....343541	343541
11.1	Description of Vapor Recovery System	353743

11.2	Description of In-Station Diagnostics (ISD).....	<u>373844</u>
11.3	Compatibility.....	<u>373945</u>
11.4	Reliability of the System	<u>383945</u>
11.5	Installation, Operation, and Maintenance of the System	<u>384046</u>
11.6	Evidence of Financial Responsibility.....	<u>394046</u>
11.7	Warranty.....	<u>394046</u>
11.8	Test Station	<u>394046</u>
11.9	Notification of Certified System Component Manufacturers	<u>394147</u>
11.10	Equipment Defect Identification and Test Protocols.....	<u>404147</u>
11.11	Challenge Modes and Test Protocols	<u>404147</u>
11.12	Other Information.....	<u>404147</u>
12.	EVALUATION OF THE APPLICATION	<u>404248</u>
12.1	Performance Standards and Specifications	<u>414248</u>
12.2	Bench and Operational Testing Results.....	<u>414248</u>
12.3	Evaluation of System Concept.....	<u>414248</u>
12.4	Materials Specifications and Compatibility with Fuel Formulations	<u>414349</u>
12.5	Installation, Operation and Maintenance Manuals	<u>414349</u>
12.6	Equipment Defect Identification	<u>414349</u>
12.7	Challenge Mode Determination	<u>424349</u>
13.	VAPOR RECOVERY SYSTEM CERTIFICATION TESTING	<u>424349</u>
13.1	Test Site for Field Testing of Vapor Recovery Systems	<u>434450</u>
13.2	Bench Testing of Components.....	<u>444652</u>
13.3	Operational Test of at Least 180 Days.....	<u>444652</u>
13.4	Equipment Defect and Challenge Mode Testing.....	<u>454753</u>
13.5	Efficiency and/or Emission Factor Test.....	<u>454753</u>
13.6	Vehicle Matrix.....	<u>464753</u>
14.	ALTERNATE TEST PROCEDURES AND INSPECTION PROCEDURES	<u>464854</u>
14.1	Alternate Test Procedures for Certification Testing.....	<u>474854</u>
14.2	Request for Approval of Alternate Test Procedure.....	<u>474854</u>
14.3	Response to Request.....	<u>474955</u>
14.4	Testing of Alternate Test Procedures.....	<u>474955</u>
14.5	Documentation of Alternate Test Procedures	<u>474955</u>
14.6	Inspection Procedures.....	<u>484955</u>
15.	DOCUMENTATION OF CERTIFICATION	<u>485056</u>
15.1	Executive Order.....	<u>485056</u>
15.2	Summary of Certification Process.....	<u>485056</u>
16.	DURATION AND CONDITIONS OF CERTIFICATION	<u>485056</u>
16.1	Duration of System Certification	<u>495056</u>
16.2	One Vapor Recovery System per UST System	<u>495056</u>
16.3	Certification Not Transferable	<u>495157</u>
16.4	Financial Responsibility	<u>495157</u>
16.5	Warranty.....	<u>505157</u>
16.6	Installation, Operation and Maintenance of the System.....	<u>505258</u>

16.7	Identification of System Components.....	515258
16.8	Compliance Enforcement	515359
16.9	Revocation of Certifications	515359
17.	CERTIFICATION RENEWAL.....	515359
17.1	Request for Renewal	525460
17.2	Review Request	525460
17.3	Evaluation of System Deficiencies.....	535460
17.4	Letter of Intent	535561
17.5	Renewal of Executive Order	545562
17.6	Denial of Executive Order Renewal	545562
18.	AMENDMENTS TO EXECUTIVE ORDERS	545662
18.1	Request for Amendment.....	555662
18.2	Review of the Request.....	555763
18.3	Testing	575864
18.4	Letter of Intent	575864
18.5	Issuance of Executive Order.....	575965
19.	REPLACEMENT OF COMPONENTS OR PARTS OF A SYSTEM WITH A TERMINATED, REVOKED, SUPERSEDED OR EXPIRED CERTIFICATION	575965
19.1	Component and Replacement Parts	575965
19.2	Component or Replacement Part Not Meeting Specifications.....	585965
19.3	Component or Part Not Certified with System and Not Meeting Specifications ..	586066
19.4	Procedure for Approval of Replacement Parts.....	586066
20.	REQUIREMENTS FOR, AND CERTIFICATION OF, LOW PERMEATION HOSES ...	596066
20.1	Request for Certification	596066
20.2	Hose Lengths	606167
20.3	Identification of Certified Hose	606167

LIST OF TABLES

<u>Table</u>	<u>Title</u>	<u>Page</u>
2-1	Effective and Operative Dates for Phase I and Phase II Vapor Recovery Performance Standards and Specifications	54
3-1	Phase I Performance Standards and Specifications Applicable to All Phase I Vapor Recovery Systems	6
4-1	Phase II Performance Standards and Specifications Applicable to All Phase II Vapor Recovery Systems	1211
4-2	Phase II Nozzle Spout Assembly Dimensions Including Nozzle Bellows	17
5-1	Phase II Performance Standards and Specifications Applicable to Phase II Balance Vapor Recovery Systems	212329
6-1	Phase II Performance Standards and Specifications Applicable to All Phase II Vacuum Assist Systems	232531

7-1	Phase II Performance Standards and Specifications Applicable to All Phase II Assist Systems Utilizing A Central Vacuum Unit.....	2526 <u>32</u>
8-1	Phase II Performance Standards and Specifications Applicable to All Phase II Systems Utilizing A Destructive Processor	2527 <u>33</u>
8-2	Phase II Performance Standards and Specifications Applicable to All Phase II Systems Utilizing A Non-Destructive Processor	2628 <u>34</u>
11-1	Estimated Timeline for the Certification Application Process	3536 <u>42</u>
17-1	Estimated Timeline for the Renewal Process	5455 <u>61</u>

LIST OF FIGURES

<u>Figure</u>	<u>Title</u>	<u>Page</u>
3A	Phase I Product Adaptor Cam and Groove Specification	147
3B	Phase I Vapor Recovery Adaptor Cam and Groove Specification	147
4A	Phase II Nozzle Spout Dimensions as Specified by Table 4-2.....	19
4B	Phase II Nozzle Bellows Dimensions as Specified by Table 4-2.....	20
4C	<u>Fill Pipe Access Zone for Comparison to Nozzles with Spout Angles Outside of the Range Specified in Table 4-2 (Sα of 19.5° to 26.0°)</u>	<u>23</u>
4D	<u>Fill Pipe Access Zone for Comparison to Nozzles with Spout Angles Outside of the Range Specified in Table 4-2 (Sα of 19.5° to 26.0°)</u>	<u>24</u>
4E	<u>Fill Pipe Latching Templates for Comparison to Nozzles with Spout Angles Outside of the Range Specified in Table 4-2 (Sα of 19.5° to 26.0°)</u>	<u>25</u>
4F	<u>Zone Placement for Vehicle Usage for Comparison to Nozzles with Spout Angles Outside of the Range Specified in Table 4-2 (Sα of 19.5° to 26.0°)</u>	<u>26</u>
4G	<u>Nozzle Vehicle Clearance for Comparison to Nozzles with Spout Angles Outside of the Range Specified in Table 4-2 (Sα of 19.5° to 26.0°)</u>	<u>26</u>

4. PHASE II PERFORMANCE STANDARDS AND SPECIFICATIONS APPLICABLE TO ALL PHASE II VAPOR RECOVERY SYSTEMS

Table 4-2
Phase II Nozzle Spout Assembly Dimensions Including Nozzle Bellows

(Figures 4A and 4B illustrate the dimensions and correspond to the symbols in Table 4-2.)

<u>Symbol</u>	<u>Description</u>	<u>Dimension Range (Minimum/Maximum)</u>
<u>D₁</u>	<u>Spout Outside Diameter</u> <u>Minimum Length of D₁</u> <u>Roundness of D₁</u>	20.4250 /21.34 mm (0.792807/0.840 in) <u>L₂ – A₁</u> <u>Within diameter limits</u>
<u>D₂^(a)</u>	<u>Nozzle Anchor Device Outside Diameter^(a)</u>	<u>25.1/32.1 mm (0.988/1.264 in)^(a)</u>
<u>C_t</u>	<u>Spout Tip Chamfer or Radius</u>	<u>2.0 mm max (0.080 in max)</u>
<u>C_a</u>	<u>Spout Tip Chamfer Angle</u>	<u>30° to 45°</u>
<u>A_r</u>	<u>Anchor Radius</u>	<u>1.5 mm max (0.059 in max)</u>
<u>A_a</u>	<u>Anchor minimum angle</u>	<u>45°</u>
<u>A₁</u>	<u>Overall Length of Anchor</u>	<u>6.5/20.2 mm (0.256/0.795 in)</u>
<u>A₂</u>	<u>Length of Anchor without Chamfer</u>	0.5 /12.5 mm max (0.020/0.500 in max)
<u>A_H^(b)</u>	<u>Anchor Latch Height^(b)</u>	<u>Maximum for all styles constrained by D₂^(b)</u> <u>Minimum for Balance Nozzles:</u> <u>2.59 mm (0.102 in)</u> <u>Minimum for Assist Nozzles:</u> <u>3.50 mm (0.138 in)</u>
<u>S_a^(c)</u>	<u>Bend Angle of Nozzle Spout^(c)</u>	<u>19.5° / 26.0°^(c)</u>
<u>L₁</u>	<u>Length of Straight Part of Nozzle Spout</u>	<u>L₂ + 5.0 mm min</u> <u>(L₂ + 0.197 in min)</u>
<u>L₂</u>	<u>Distance Between Nozzle End and First Anchor Position</u>	<u>85.0/95.0 mm (3.346/3.740 in)</u>
<u>L₃^(d)</u>	<u>Distance Between Nozzle End and Aspirator Port Centerline^(d) (Aspirator can be in front face of tip)</u>	<u>18.0 mm max (0.709 in max)^(d)</u>
<u>L₄</u>	<u>Clearance from Fuel Dispensing End to Spout Connection to Nozzle Body</u>	<u>150 mm min (5.906 in min)</u>
<u>B₁</u>	<u>Nozzle Bellows Face Outer Diameter</u>	<u>77 mm max (3.031 in max)</u>
<u>B₂</u>	<u>Nozzle Bellows Face Inner Diameter</u>	<u>29.0/45.0 mm (1.142/1.772 in)</u>

Table 4-2 (continued)

Phase II Nozzle Spout Assembly Dimensions Including Nozzle Bellows

(Figures 4A and 4B illustrate the dimensions and correspond to the symbols in Table 4-2.)

<u>Symbol</u>	<u>Description</u>	<u>Dimension Range (Minimum/Maximum)</u>
<u>B₃</u>	<u>Nozzle Bellows Face Flatness Profile</u>	<u>2.5 mm (0.098 in) total indicator reading (TIR) max over seal surface profile tolerance on seal surface</u>
<u>B₄</u>	<u>Nozzle Bellows Contact Angle</u>	<u>40° maximum angle</u>
<u>P^(e)</u>	<u>Aspirator Port Diameter^(e)</u>	<u>2.00/4.25 mm (0.079/0.167 in)^(e)</u>
<u>H</u>	<u>Calibration Hole^(f)</u>	<u>^(f)</u>

- (a) If an offset anchor is utilized, anchor outside diameter measurement will be the effective length (greatest length) across the anchor surface.
- (b) Measurement of anchor latch height (A_H) taken from ~~spout to virtual sharp~~ anchor largest diameter to spout diameter.
- (c) If spout bend angle (S_a) is out of the recommended range, ~~full nozzle review is mandatory in the vehicle fill pipe clearance zone described in the SAE recommended practice document J1140~~ the nozzle spout assembly and body must be able to be inserted within the vehicle fill pipe access zone defined in Section 4.7.4.
- (d) If L₃ is greater than 18.0 mm (0.709 in) the distance difference between L₂ and L₃ must be greater than 69 mm (2.72 in), and L₃ can be no greater than 25.4 mm (1.000 in).
- (e) Reference only dimension. Aspirator (sensor) placement can be in spout end or along bottom of spout.
- (f) Reference only dimension. Calibration holes may be present in nozzle bellows to avoid premature shutoff caused by excess vacuum during the refueling of ORVR equipped vehicles. Such holes shall be blocked/sealed during V/L ratio nozzle adjustments.

Figure 4A
Phase II Nozzle Spout Dimensions as Specified by Table 4-2

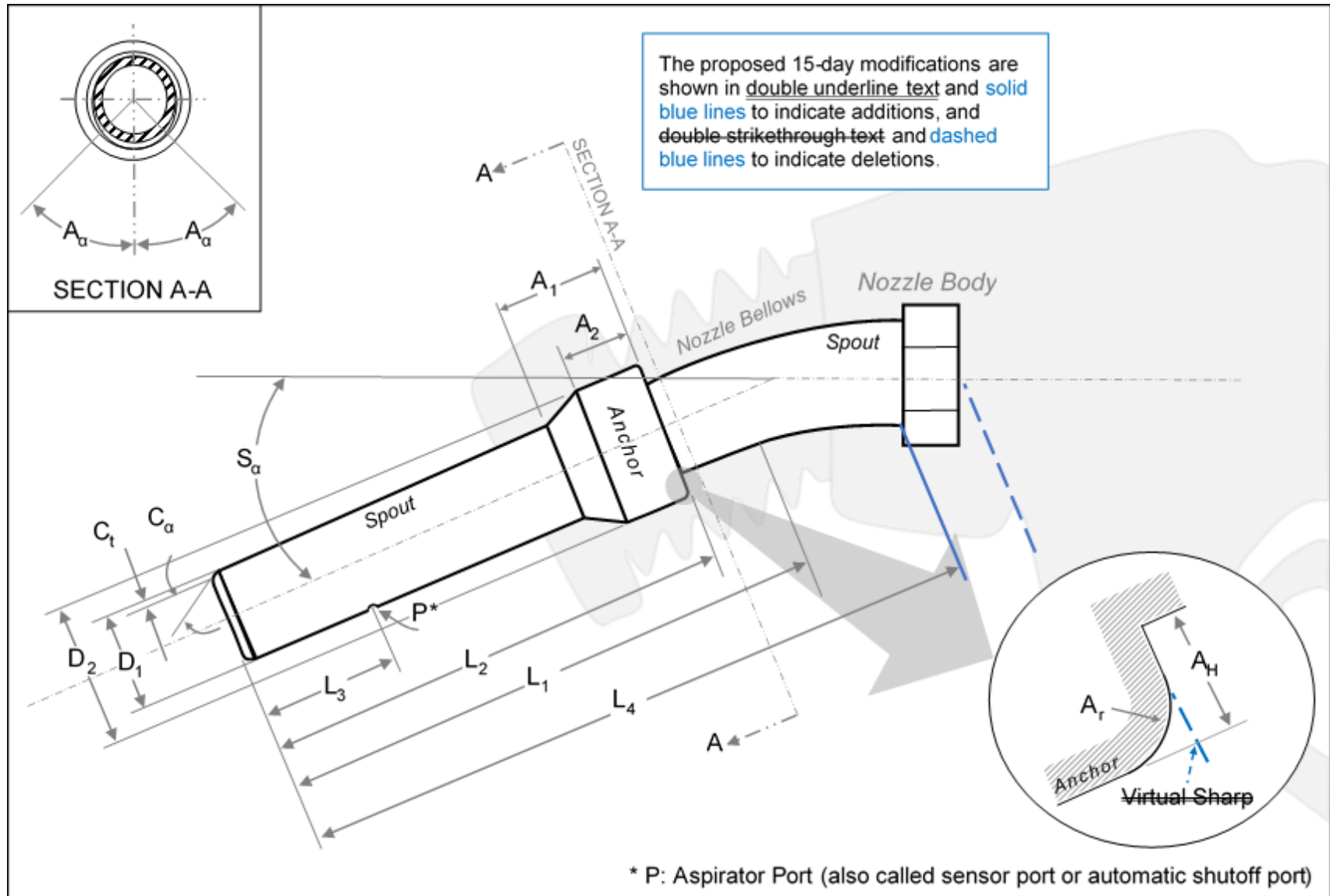
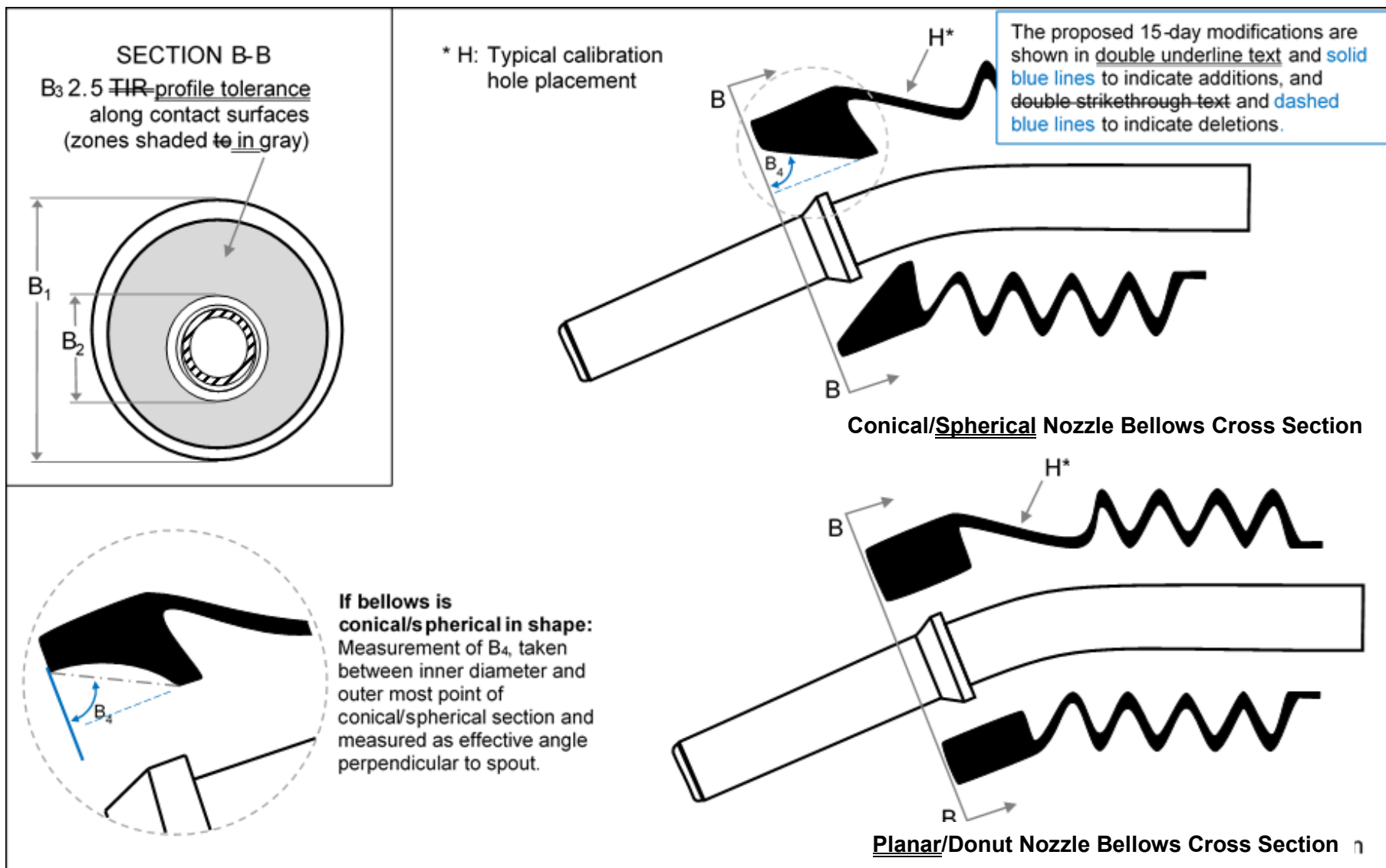

Figure 4B
Phase II Nozzle Bellows Dimensions as Specified by Table 4-2



4.7.4 If a Phase II EVR nozzle spout's bend angle is outside of the range specified in Table 4-2 (S_{α} of 19.5° to 26.0°), the nozzle spout assembly and body must be able to be inserted within the vehicle fill pipe access zone defined by the following geometries.

- (a) Zone construction of fill pipe access zone (Figure 4C).
- (b) A fill pipe face that is flat within 0.25 mm profile tolerance and has a smooth surface against which a Phase II EVR nozzle can affect a vapor-tight seal.
- (c) The fill pipe and all surrounding bumpers, body parts, and factory-installed accessories designed and fabricated so that the fill pipe access zone allows for insertion of a Phase II EVR nozzle in at least one orientation within ± 15 degrees swing of the upright or vertical position. It is recommended that the zone be based on the vertical since this is the primary customer filling position.
- (d) Allowance must be made for production tolerances as these are not included in the access zone.
- (e) The access zone consists of three parts as follows:
 - (1) A bellows interface zone with a fixed circular shaped cross section that is fixed relative to the sealing surface of the fill pipe and designed to accommodate the sealing portion of a Phase II EVR nozzle. Additional clearance for the Phase II EVR nozzle is prescribed per Figure 4D from the seal surface of the nozzle and pipe, a clearance inward of the pipe to a depth of 12 mm along a 40° cone to the seal surface of the fill pipe.
 - (2) A nozzle swing zone with a rectangular cross-section tapered at the bottom that accommodates the handle portion of a nozzle. This zone is the portion shown on Figure 4C, within the lines defined by points C, D, E, F, and G.
 - (3) A transition zone consisting of a smooth blend from the rectangular nozzle swing zone to the circular bellows zone. The top of this transition zone is the line G-H in Figure 4C and the bottom of this zone is Line A-C.
- (f) Zone construction of fill pipe latching templates (Figure 4E). The templates shown in Figure 4E are for usage with nozzle insertion clearance review. There are nozzle resting and nozzle insertion position templates.
 - (1) The nozzle resting position template simulates a vehicle fill pipe with a minimum height locking lip, minimum depth locking lip, and a centered pipe expansion. A cross-section and face view are shown with appropriate

dimensions to simulate the worst case lower handle position when the nozzle anchor is placed into the latched position and nozzle spout end is installed into the centered expansion inner diameter.

(2) The nozzle insertion position template simulates a vehicle fill pipe with a maximum height locking lip, maximum latching lip depth and a maximum pipe inner diameter. A cross-section and face view are shown with appropriate dimensions to simulate the worst case upper nozzle swing position when the nozzle anchor is resting on the latching lip and nozzle spout end contacts fill pipe interior diameter.

(g) Zone placement (Figures 4F and 4G).

(1) For usage in vehicle clearance, align the centerline of the bellows interface zone with the centerline of the fill pipe-sealing surface. See Figure 4F for example.

(2) For usage with nozzle insertion clearance, the following steps apply:

(i) Align the centerline of the bellows interface zone with the centerline of the nozzle resting position template.

(ii) Superimpose the nozzle design into the model, positioning the nozzle spout into a resting position as shown in Figure 4G. No sections of nozzle can encroach the boundaries of the zone. Design should be reviewed with bellows compressed to seal surface of template.

(iii) Align the centerline of the bellows interface zone with the centerline of the nozzle insertion position template.

(iv) Superimpose the nozzle design into the model, positioning the nozzle spout into an insertion position as shown in Figure 4G. No sections of nozzle can encroach the boundaries of the zone. Design should be reviewed with bellows compressed to seal surface of template.

4.7.45 Additional nozzle criteria are contained in Sections 5 and 6.

Figure 4C
Fill Pipe Access Zone for Comparison to Nozzles with Spout Angles Outside of the
Range Specified in Table 4-2 (S_{α} of 19.5° to 26.0°)

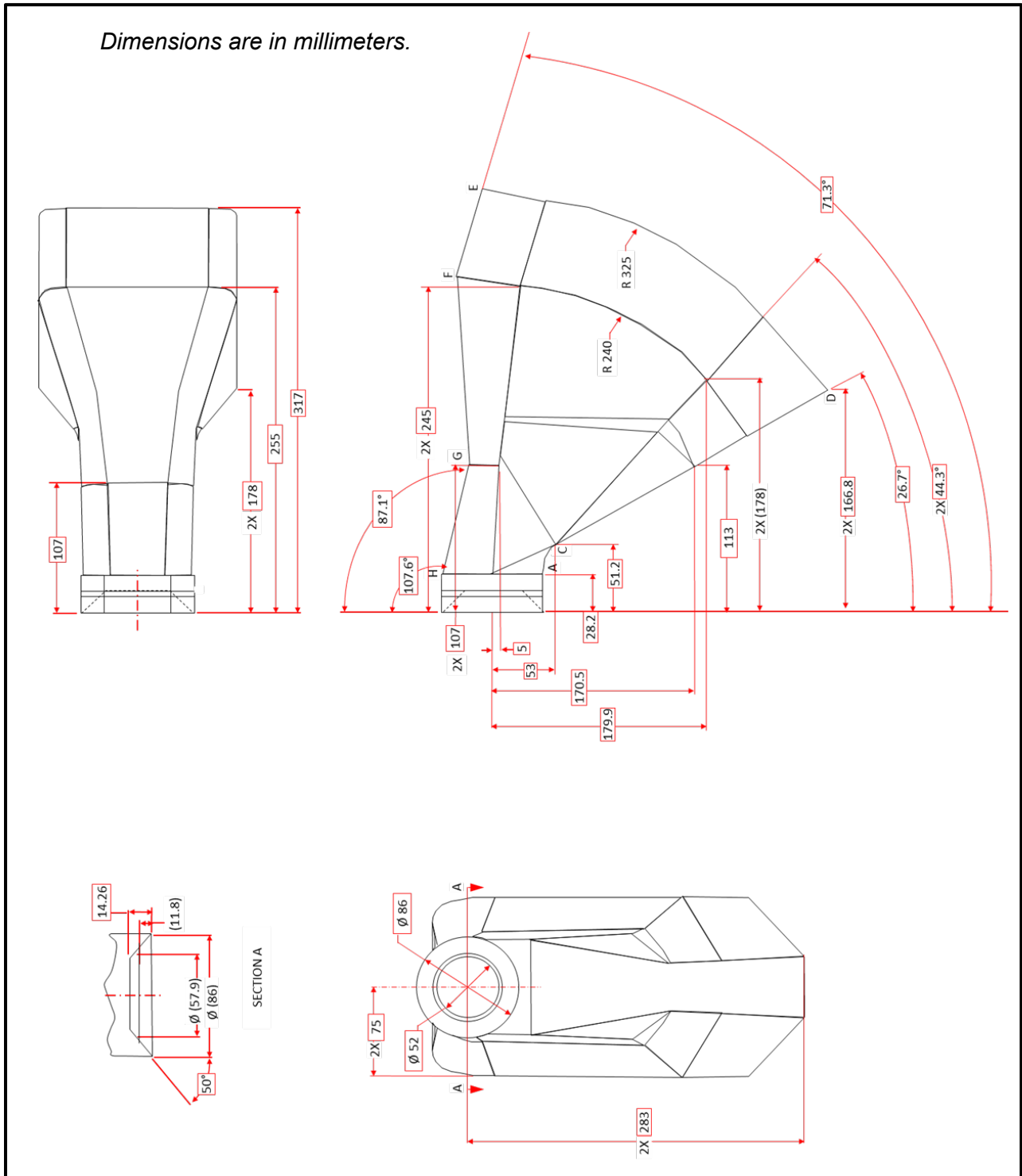

Figure 4D
Fill Pipe Access Zone for Comparison to Nozzles with Spout Angles Outside of the Range Specified in Table 4-2 (S_α of 19.5° to 26.0°)

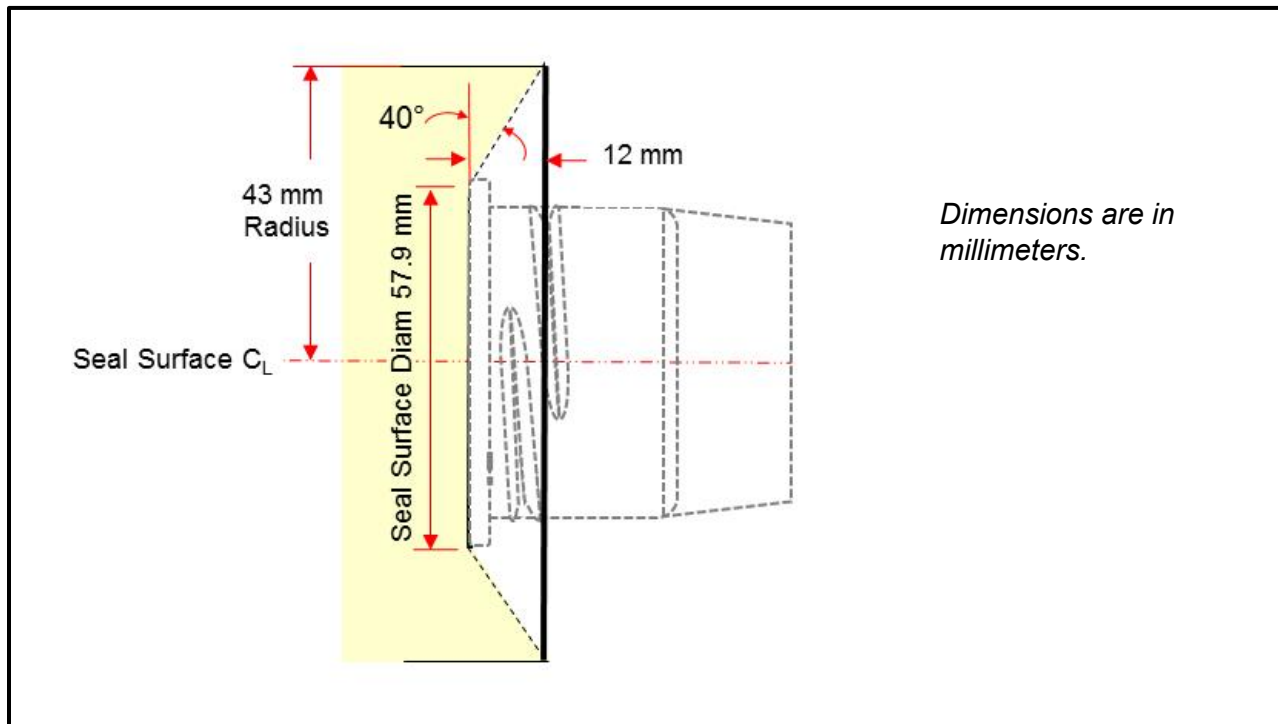

Figure 4E
Fill Pipe Latching Templates for Comparison to Nozzles with Spout Angles Outside
of the Range Specified in Table 4-2 (S_{α} of 19.5° to 26.0°)

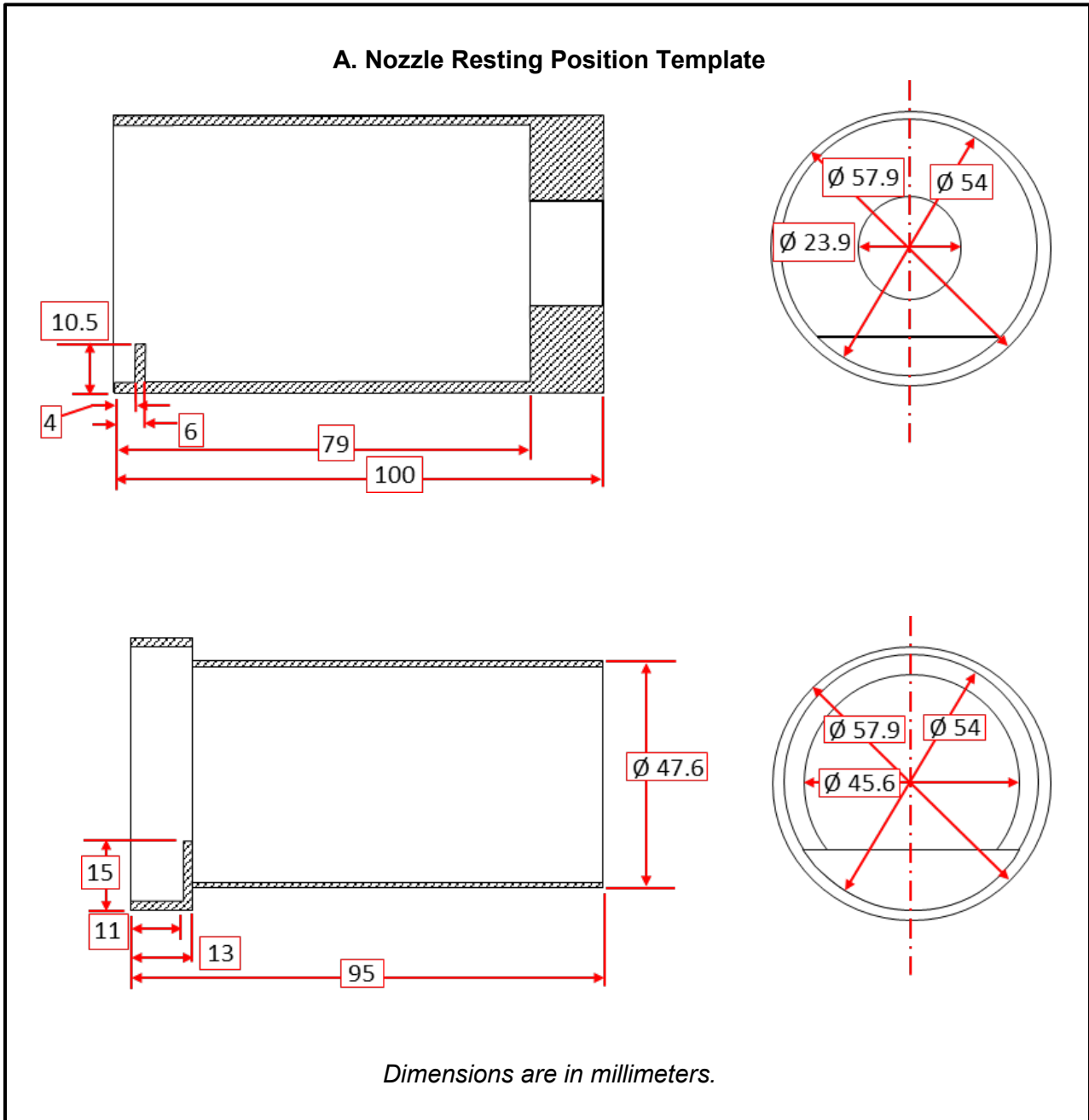

Figure 4F
Zone Placement for Vehicle Usage for Comparison to Nozzles with Spout Angles Outside of the Range Specified in Table 4-2 (S_{α} of 19.5° to 26.0°)

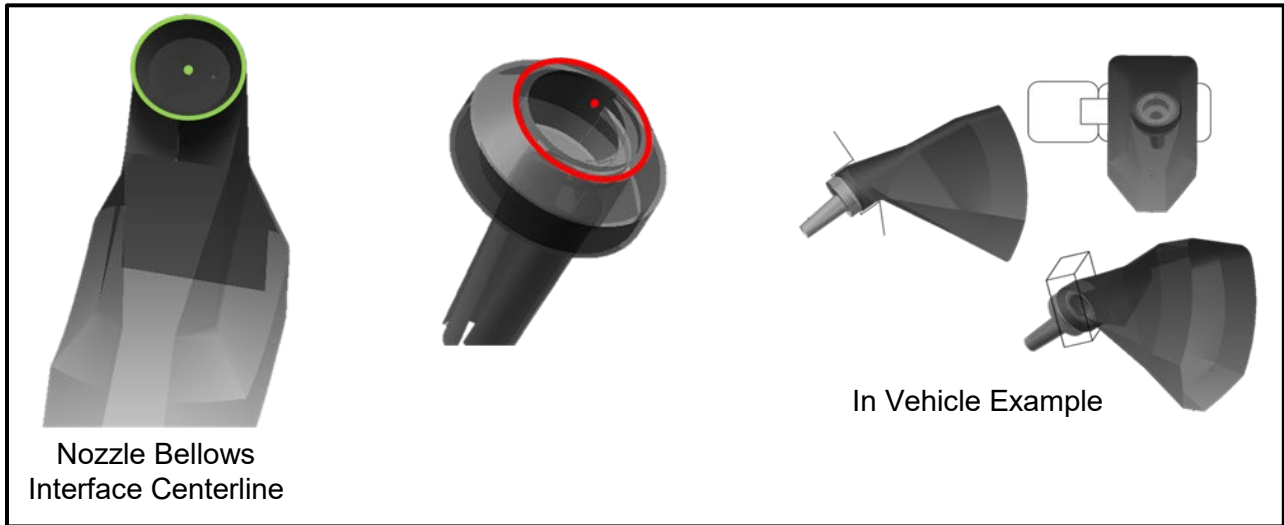

Figure 4G
Nozzle Vehicle Clearance for Comparison to Nozzles with Spout Angles Outside of the Range Specified in Table 4-2 (S_{α} of 19.5° to 26.0°)

