



CARB's Racial Equity Lens

Community Meeting
January 7th, 2025

Translating Audio

- At the bottom of the Zoom controls, click **Interpretation**
- Select your preferred language (**English** or **Spanish**)
- To only hear the interpreted language, select **Mute Original Audio**

Technical difficulties? Message Aldo Chaney or email equity@arb.ca.gov

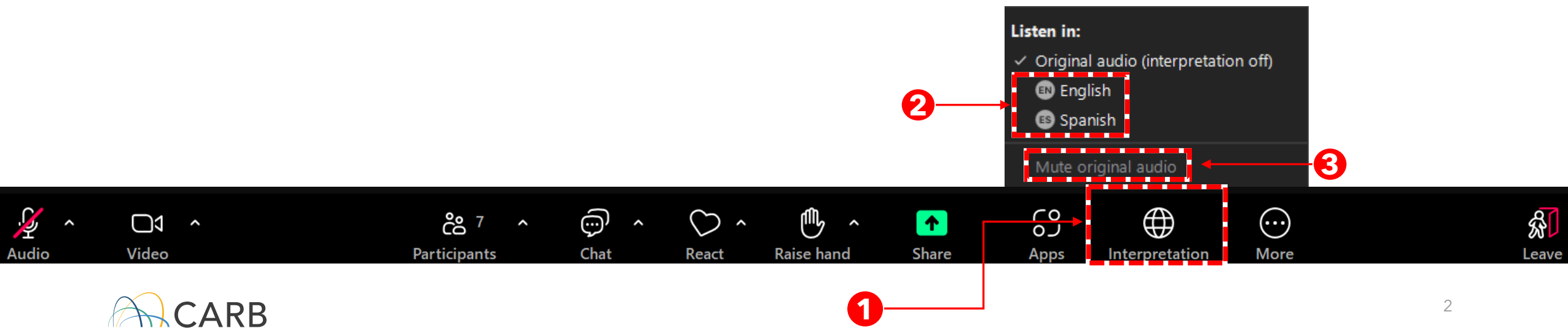

Translating Visual

- At the top of the Zoom window, there are two screen options, one with English slides **[ES]** and one with Spanish slides **[DE]**.
- Select "**Diapositivas en Español's screen**" or "**English Slides's screen**".

Technical difficulties? Message Aldo Chaney or email equity@arb.ca.gov



Mute/Unmute

Please remain on mute when you are not speaking.

- ZOOM: Click the **Audio** button at the bottom left to mute/unmute
- PHONE: **Dial *6** to mute/unmute

Technical difficulties? Message Aldo Chaney or email equity@arb.ca.gov

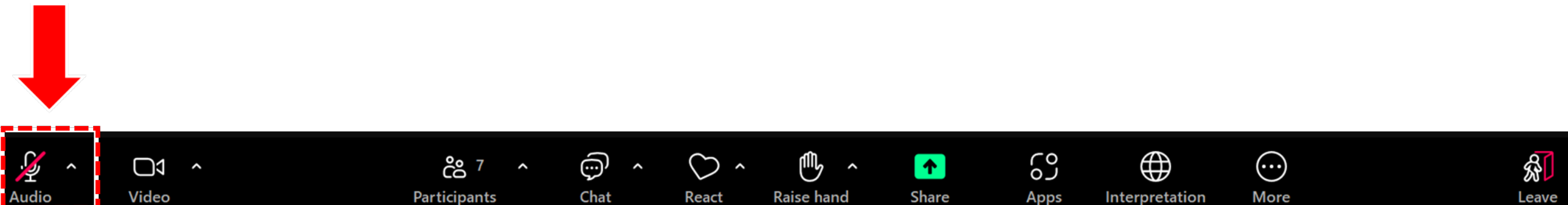

Video

Click the **camera** icon at the bottom left of your screen to toggle your video on and off.

Technical difficulties? Message Aldo Chaney or email equity@arb.ca.gov

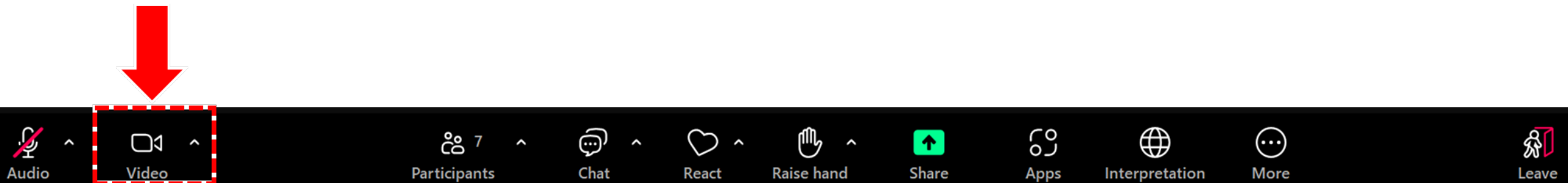

Chat

- Click on the **chat** icon near the center bottom of your screen.
- Choose "private" chat to chat with the Host or Co-host
- Private chats are archived.

Technical difficulties? Message Aldo Chaney or email equity@arb.ca.gov

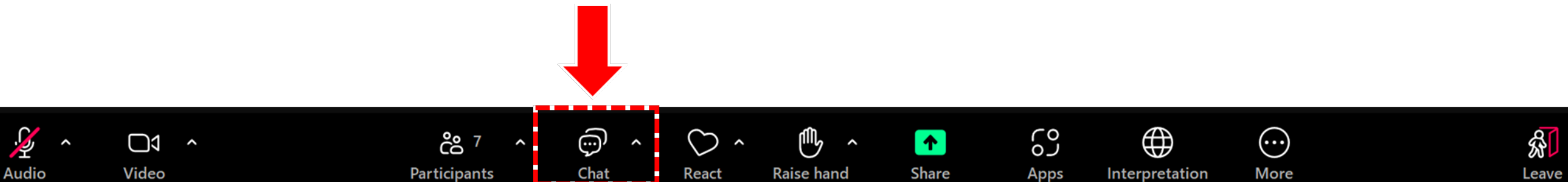

Raise Hand

To be added to the speaking queue, please use the **Raise Hand** feature.

- ZOOM: Click the **Raise Hand** button in the bottom center of the screen.
- PHONE: **Dial #2** to raise/lower hand

Technical difficulties? Message Aldo Chaney or email equity@arb.ca.gov

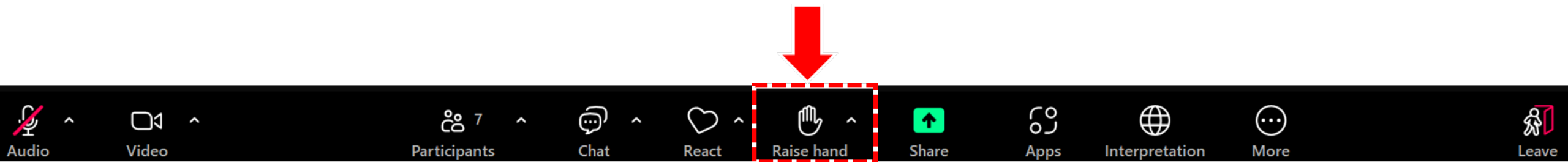

Agenda

- Welcome
- Equity at CARB
- CARB's Racial Equity Lens and Q&A
- Ground truthing CARB's Racial Equity Lens and Q&A
- Discussion
- Closing remarks

CARB's Mission

CARB is charged with protecting the public from harmful air pollution and climate change.



CARB's Vision for Racial Equity

CARB works toward a future where all Californians breathe healthy and clean air, benefit from actions to address climate change, and where race is no longer a predictor of life outcomes.

CARB's Commitments to Organizational Change

CARB Resolution 20-33

Establish and advance racial equity in social justice measures in all CARB actions.

Governor's Executive Order N-16-22

Directs state agencies to develop or update strategic plans that advance equity and respond to identified disparities.

CARB's Approach to Advancing Racial Equity

Normalize

- Use a shared racial equity framework
- Operate with urgency and accountability

Organize

- Build organizational capacity
- Partnerships with communities and other external partners

Operationalize

- Use racial equity tools
- Be data-driven



Operationalizing Racial Equity at CARB

What Are Racial Equity Tools?

Racial equity tools are a set of methodologies that can be used to identify and mitigate systemic biases within policies, programs, and practices.

Why Develop CARB's Racial Equity Lens?

Racial equity tools, like CARB's Racial Equity Lens, offer data-driven strategies to help lead with race in the development and implementation of their work.

What is CARB's Racial Equity Lens (REL)?

CARB's Racial Equity Lens (REL) is a series of racial equity-centered, data-driven questions that can be tailored to the needs of CARB's many divisions, programs, and processes.



What Does CARB's REL Currently Look Like?

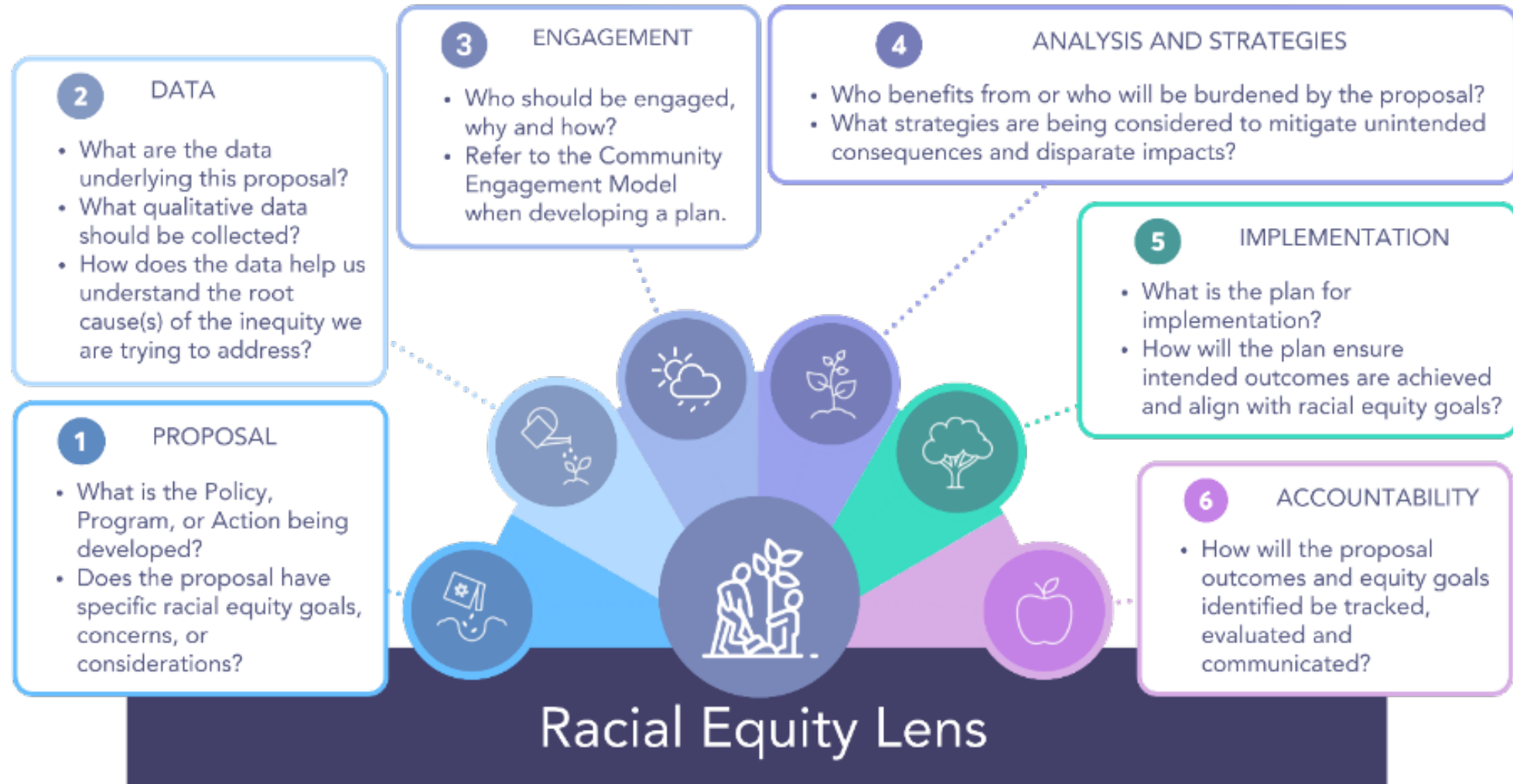

How has CARB's REL been applied so far?

Pilot exercises - report to be publicly available in 2025

- Considering racial equity in strategic planning.
- Assessing program outcomes.

Integrating racial equity into public engagement

- Combined CARB's REL and CARB's Community Engagement Model.



How does the Office of Racial Equity (ORE) support CARB's REL?

- Coordinate **agency-wide implementation** of CARB's REL
- Externally **ground truth** CARB's REL with community experts
- **Launch** CARB's (revised) REL, both internally and externally
- Support **sustained use** of CARB's REL **and iterative refinement**

Ground Truthing CARB's REL

What is ground truthing?

Ground truthing is a process that informs the development of a project based on lived and on-the-ground experiences.

Why is CARB ground truthing CARB's REL?

Ground truthing ensures that CARB's REL is effective and viable, not only in theory but also in practice, and that staff's application of the tool achieves the outcomes communities are most interested in.

What would ground truthing CARB's REL look like?

**CARB is seeking
5 community
experts to
externally
ground truth
CARB's REL.**

Community experts will **participate in four meetings**, review materials provided by CARB staff, and **share written feedback outside of meetings**

Anticipated time commitment: **March 10 - June 27 (approximately 4 months)**

Compensation: **\$2,500** + covered travel for one in-person meeting

See <https://ww2.arb.ca.gov/REL-community-expert-solicitation> **for more information.**

Who should apply to ground truth CARB's REL?

Community experts should:

- Be able to demonstrate a proven track record of a commitment to racial equity and environmental justice.
- Have a vision for CARB to advance racial equity and be willing to share that vision.
- Experience or expertise working with government organizations.
- Connection or expertise with disadvantaged, low-income communities

Full eligibility information can be found at
<https://ww2.arb.ca.gov/REL-community-expert-solicitation>.

What is the application process?

**Applications are due
January 13, 2025,
by 11:59 pm PST**

Applications must include:

- Applicant details (e.g., name, email address)
- Resume or Curriculum Vitae (CV)
- Short answer responses

**Visit <https://ww2.arb.ca.gov/REL-community-expert-solicitation> to
submit your online application.**

Five-minute Break

Please return at X:XX pm

Using :Padlet

- CARB staff will post a question in :Padlet
- Participants can share:
 - **Verbal comments** – Raise hand on Zoom and unmute when called on
 - **Written comments** - Type comment directly in :Padlet or in the Zoom chat

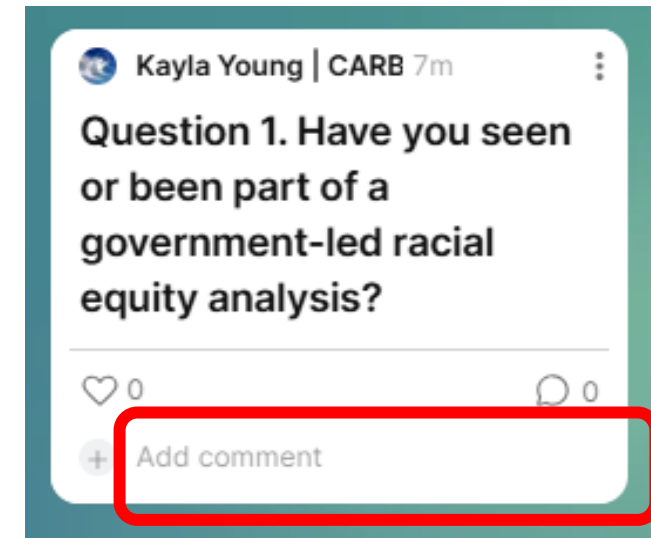

Access the :Padlet here: <https://tinyurl.com/Jan7RELpadlet>

Using :Padlet

To share comments anonymously, use the anonymous name provided to you by :Padlet

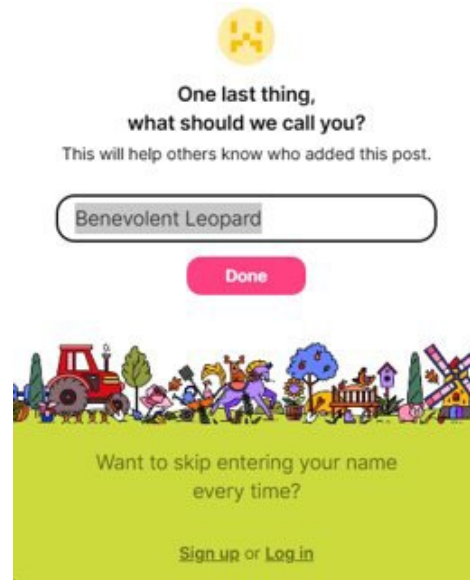

Access the :Padlet here: <https://tinyurl.com/Jan7RELpadlet>

Discussion Questions

Question 1. Have you seen or been part of a government-led racial equity analysis?

Question 2. How do you feel about CARB using a racial equity analysis tool?

Question 3. What changes or outcomes would you like CARB's REL to help achieve in your community?

Question 4. How do you envision accountability when staff apply CARB's REL?

Access the :Padlet here: <https://tinyurl.com/Jan7RELpadlet>

More Information

- CARB's vision for racial equity: <https://ww2.arb.ca.gov/equity>
- About CARB's REL: <https://ww2.arb.ca.gov/equity/REL>
- Application to ground truth CARB's REL: <https://ww2.arb.ca.gov/REL-community-expert-solicitation>
- Subscribe to CARB's equity listserv: https://public.govdelivery.com/accounts/CARB/subscriber/new?topic_id=equity

Contact CARB's Office of Racial Equity at
Equity@arb.ca.gov